



Hematology Analyzer EXZ6000

A powerful assistant for micro-volume whole blood automatic detection

EXZ6000 is an automated hematology analyzer with an autoloader that could load up to 50 samples at a time. It just consumes 20 μ L micro-volume whole blood in closed vial and test 29 parameters, 5 scatter grams and 3 histograms by advanced flow cytometry, laser scattering technology, etc. This EXZ6000 could optimize capillary blood testing process and improve your work efficiency, making it ideal for middle-size and large laboratory.



Highlight Feature

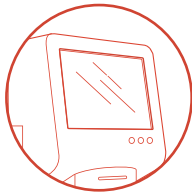

Convenient operation

- 12.1-inch touch screen with intuitive navigation menu and convenient shortcut key, easy to operate.
- One screen displays 29 parameter results and only require 1-2 steps straight access to daily operation
- L-J QC target value automatically import via U disk, instead of manual input

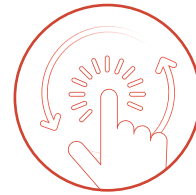

Automatic application

- One click for troubleshooting and automatic unlogging
- One press to shut down and automatically aspirate probe cleanser for deeply cleaning
- Automatic loading, mixing, sampling and testing for micro-volume whole blood.



Reliable detection

- Advanced tri-angle laser scattering technology bring you more accurate WBC 5-diff differentiation
- Expanded WBC and PLT linearity range make you more confidence in low values sample.
- Distinctive optical channel detects WBC and basophils never worry about blocking the hole.

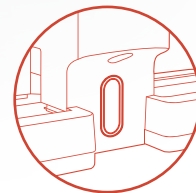

Efficient facility

- Enable CBC+DIFF throughput up to 70 samples/h, suitable for middle-volume labs.
- Only require 20 μ L micro-volume whole blood in closed vial with autoloader, applicable for pediatric dept.
- Radio Frequency (RF) technology automatically loads the reagent information without scanning barcode

Automatic Design

• Past

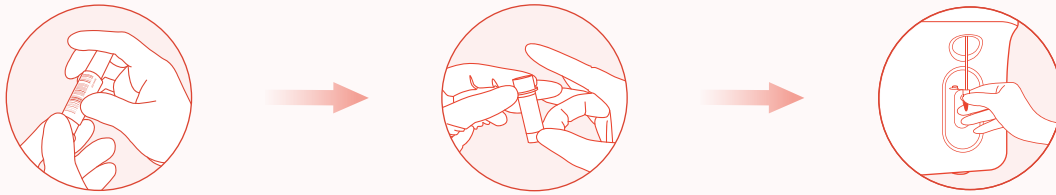

All work process by hand, like sample numbering or labelling, mixing and sampling

• Present

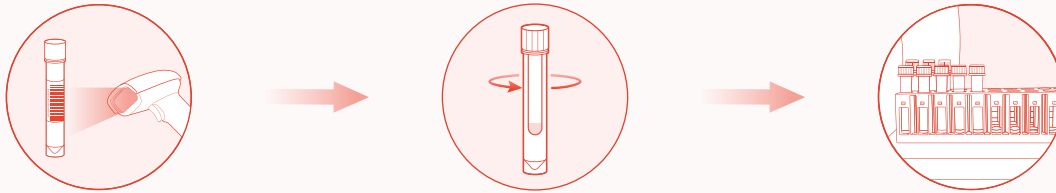

Capillary blood auto loading information, mixing and sampling test

Advanced Technology

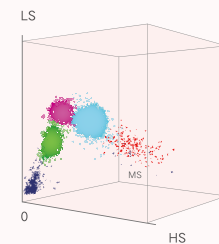
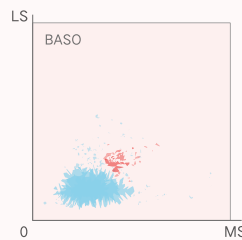
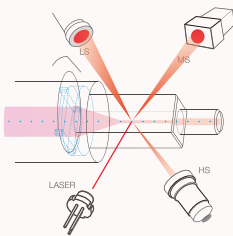

Advanced WBC 5-diff differentiation and flow cytometry technology, provide you 4 DIFF scatter grams and 1 3D scatter gram, which help you reduce manual microscopy rate

Excellent performance

Parameter	Background	Precision		Carry-over	Linearity range
		Detection Range	CV		
WBC($\times 10^9/L$)	≤ 0.2	(3.5~6.99)	$\leq 2.5\%$	$\leq 0.5\%$	0-500
		(7.0~15.0)	$\leq 2.0\%$		
RBC($\times 10^{12}/L$)	≤ 0.02	(3.50~6.00)	$\leq 1.5\%$	$\leq 0.5\%$	(0~8.00)
HGB(g/dL)	≤ 0.1	(11~18)	$\leq 1.5\%$	$\leq 0.5\%$	(0~25)
HCT (%) / MCV (fL)	HCT: ≤ 0.5	MCV: (70~120)	$\leq 0.5\%$	/	HCT: (0~67)
PLT($\times 10^9/L$)	≤ 5	(100~149)	$\leq 6.0\%$	$\leq 1.0\%$	(0~5000)
		(150~500)	$\leq 4.0\%$		

Key Specification

Principle	Flow cytometry and tri-angle laser scatter technology for WBC 5-diff differential analysis and WBC counting Impedance method for RBC and PLT counting Cyanide free reagent for HGB measurement
Analysis Mode	CBC, CBC+DIFF
Sample Volume	Autoloader mode (venous whole blood), closed vial $\leq 45 \mu\text{L}$ Autoloader mode (capillary whole blood), closed vial $\leq 20 \mu\text{L}$ Manual Mode (whole blood), open vial $\leq 20 \mu\text{L}$ Predilute mode, open vial $\leq 20 \mu\text{L}$
Maximum Throughput	CBC ≥ 90 samples/h CBC+ DIFF: ≥ 70 samples/h
Parameters	25 reportable parameters: WBC, Lym%, Mono%, Neu%, Bas%, Eos%, Lym#, Mono#, Neu#, Bas#, Eos#, RBC, HGB, HCT, MCV, MCH, MCHC, RDW-CV, RDW-SD, PLT, MPV, PCT, PDW, P-LCR, P-LCC 4 research parameters: ALY%, ALY#, LIC%, LIC#
Graph	3-D DIFF scatter gram 3 2-D DIFF scattergram
Reagent	H56 LD- I Lyse, H56 LD- II Lyse, Z5 LB Lyse, Z5 DN Diluent and Probe Cleanser
Calibration	Manual calibration Auto calibration: Fresh blood, calibrator
QC Rule	L-J, X-B
Screen	12.1-inch touch screen
Loading Capacity	Up to 50 samples tubes
Interface	4 USB port for external printer, external barcode scanner, mouse, keyboard, etc. 1 network port, HL7 protocol, support LIS.
Storage Capacity	$\geq 100,000$ results including numeric and graphical information
Power Supply	≤ 250 VAN, (100-240) V~, 50 Hz / 60 Hz
Operation Environment	Temperature: (10-32) °C Humidity: (30-85) % Atmospheric Pressure: (70-106) kPa
Weight	≤ 61 Kg
Dimension (mm)	$\leq 640(\text{W}) * 660(\text{D}) * 610(\text{H})$



Zybio Inc.

Address: Floor 1 to Floor 5, Building 30, No.6 of Taikang Road,
Block C of Jianqiao Industrial Park, Dadukou District, Chongqing, China 400082
Tel: +86-23 6895 9999 Fax: +86-23 6869 9779
Email: info@zybio.com Website: www.zybio.com

EN-XY-EXZ6000-20221209H

Hematology